

Installation Instructions



3000 Opener Spring Rod Spacer Kit



When you see this symbol, the subsequent instructions and warnings are serious - follow without exception. Your life and the lives of others depend on it!

General Information

These instructions explain how to install the update spring rod spacer kit.

Assembly Instructions

Figure 1

1. Detach old spring rod from opener by removing cotter pins (1) and clevis pins (2) from both ends. Disassembly by unscrewing the yoke (3), jam nut (4) and flange nut (5) from the rod. Slide off the spring can (6), spring (7) and trunion casting (8). Do not discard, reuse. Discard bolt (9) and long yoke (3).

Figure 2

2. Reassemble. Slide new bolt (10) into the casting. Slide the spring (7) onto the casting and retain in place with the spring can (6), spacer tube (11) and flange nut (5). Tighten the flange nut, to the dimension shown in Figure 3.
3. Tighten the jam nut (4) against the flange nut to lock it in place. Apply LOCTITE 242 or equivalent threadlocker to the last few threads, and install yoke (12) onto the assembly. Adjust to the dimension shown in Figure 3.

Reconnect spring rod onto to opener reusing cotter pins (1) and clevis pins (2).

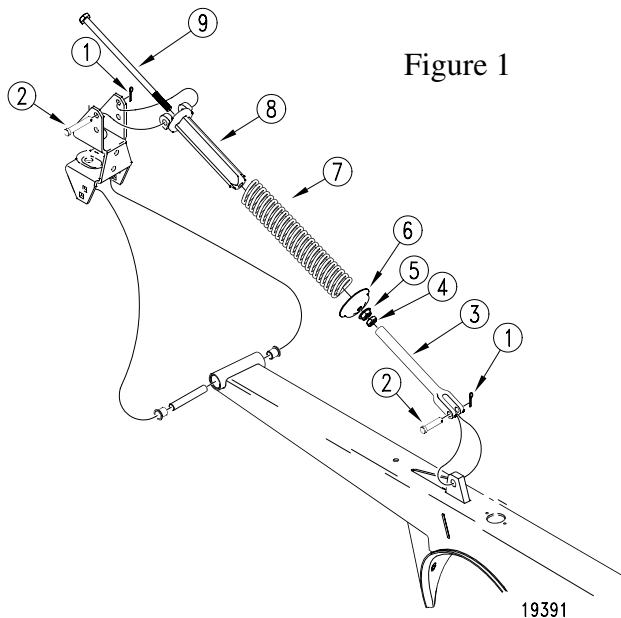

Figure 1

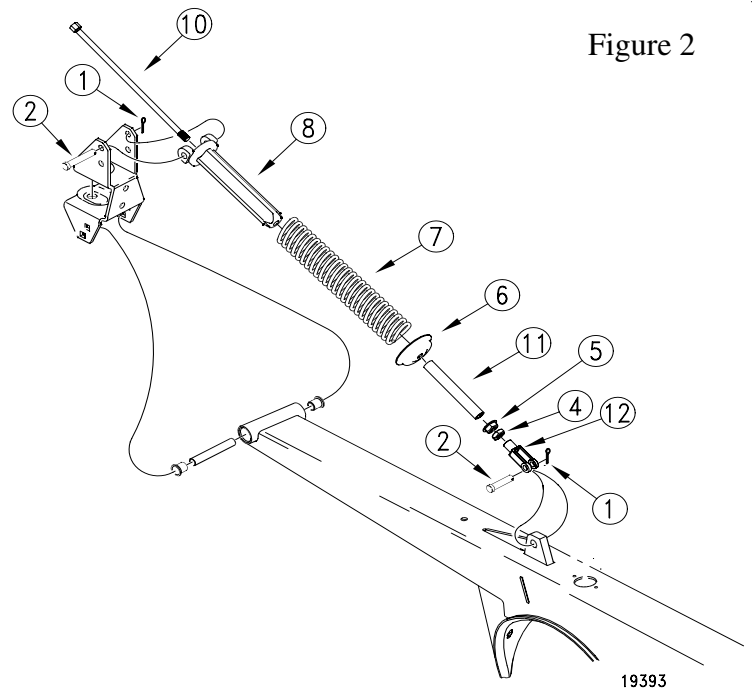

Figure 2

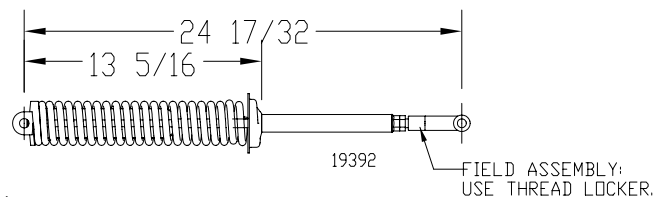

Figure 3